

Develop your projects collaboratively in an open workflow



Collaborative workflow

Using Open **BIM** technology, it is possible to implant a collaborative workflow to develop architecture, engineering and construction projects in an open and coordinated manner amongst all the technical specialists that make up the work team.



Collaborative, simultaneous and coordinated work

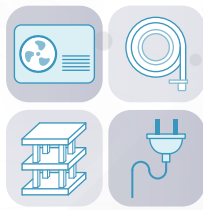

Direct communication between applications

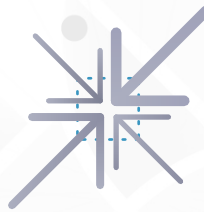

Meeting place between professionals and institutions

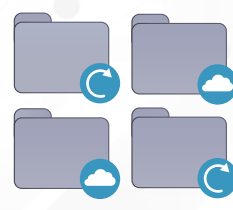

Direct and automatic file update



Exchange of information and services

Integrated development



With the proposed workflow, projects are developed in an integrated manner, since each user can carry out proposals and designs, whilst working in a simultaneous way and always keeping the project up to date with the information that has been introduced by other users.

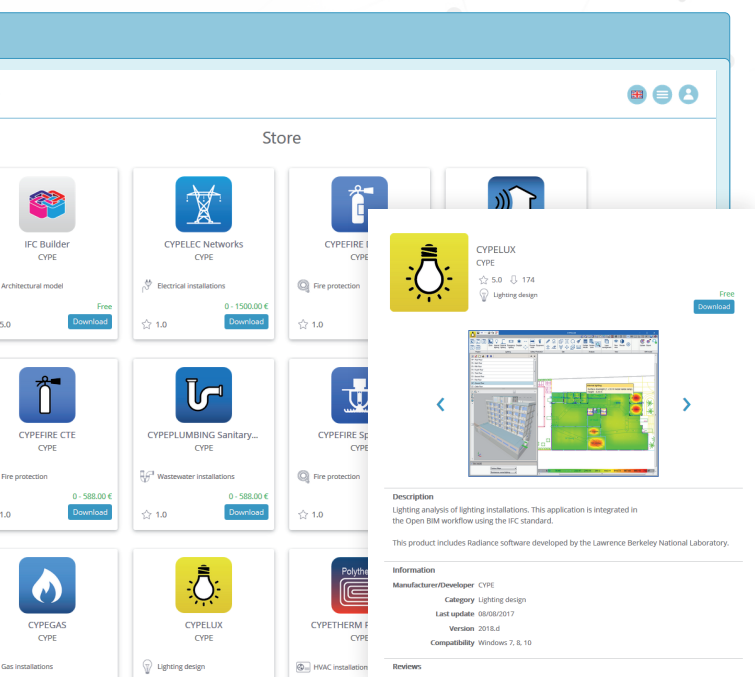

Open platform for BIM projects collaboration



BIM projects file and permission centralization



Traceability / Change control



Access from any software or device



Real time collaboration



Safe hosting



Open to any software developer



Open BIM workflow

The main property of the Open BIM workflow is that it is based on the use of IFC standard exchange files.

By working with standard formats, there is improved the communication amongst users, since these formats can be read by most tools used for project development.

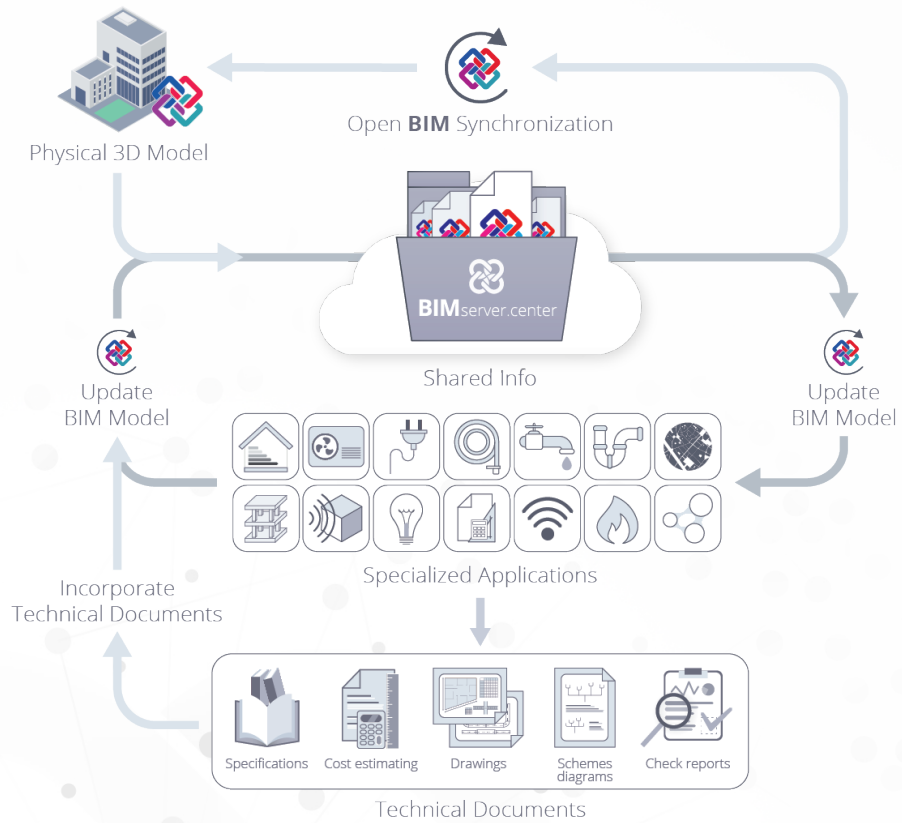

Manage, share and update your projects in the cloud.

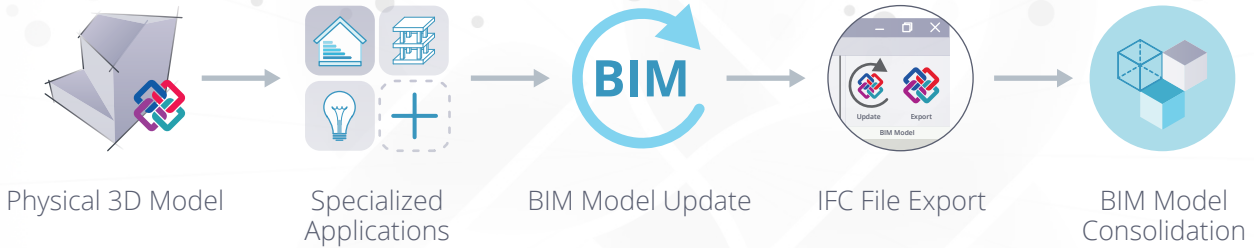

Flexibility, coordination and consolidation of the information



The consolidation of all the information that makes up the BIM project consists in including, in a single BIM model by interchanging files, all the information of the solutions adopted for each element that forms part of the project.

Furthermore, this information consolidation allows for the complete project to be generated, as a whole, and therefore detect, any possible interferences between the solutions that have been adopted.

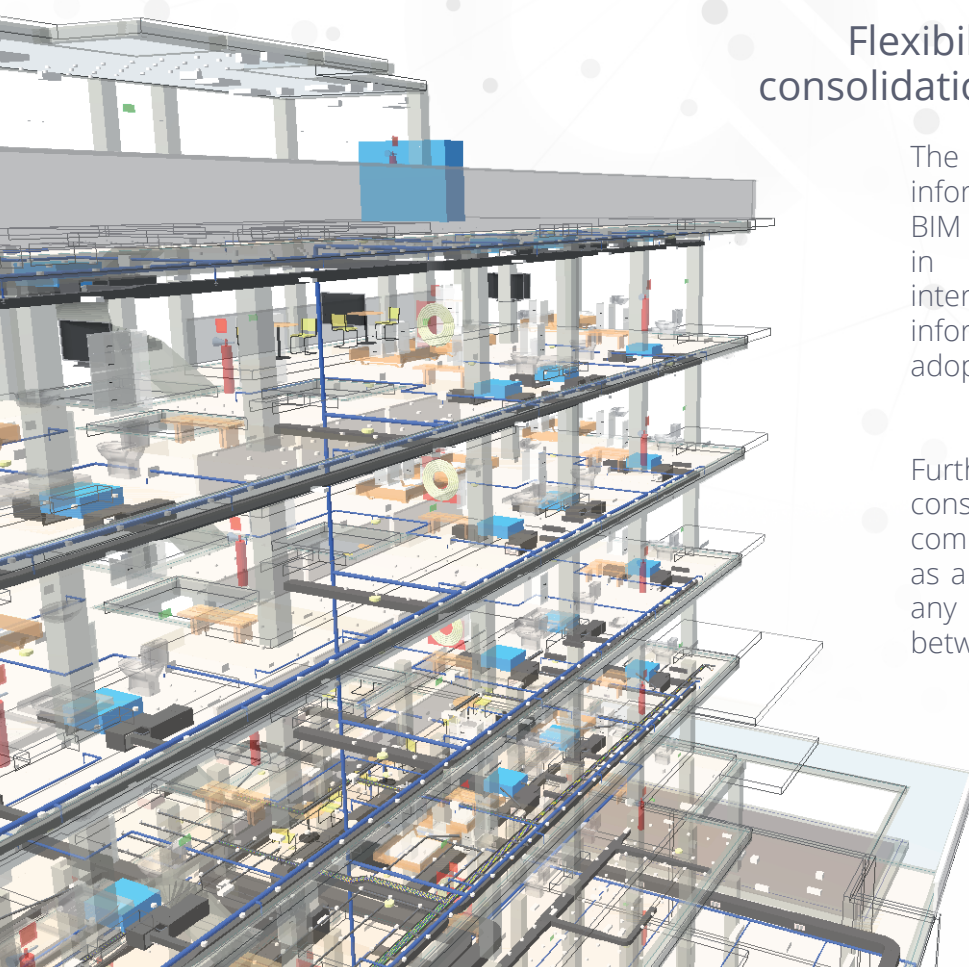

For more info, go to: bimserver.center

✉ info@bimserver.center

🐦 [@BIMservercenter](https://twitter.com/BIMservercenter) [BIMserver.center](https://www.facebook.com/BIMserver.center)